

Land use planning, its trends and use of geospatial data

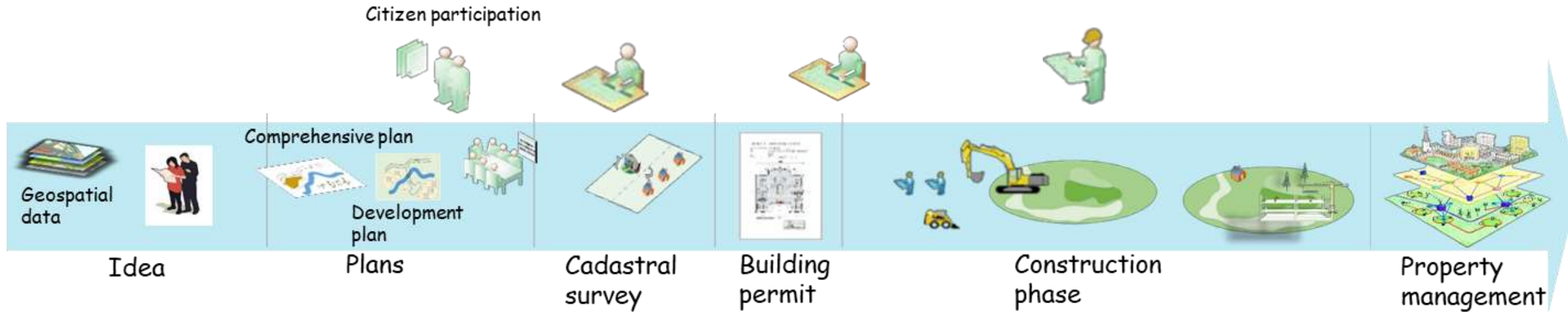

Geospatial data revolution

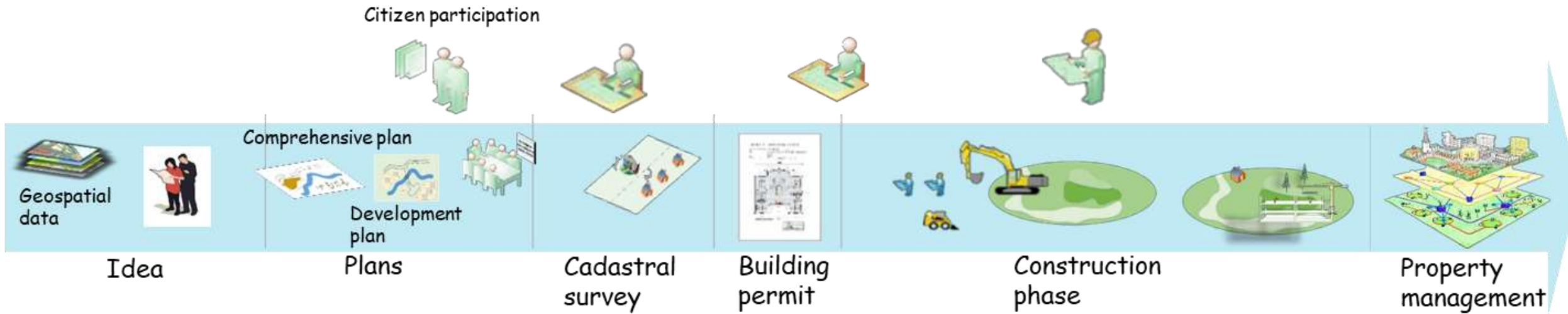

Drivers



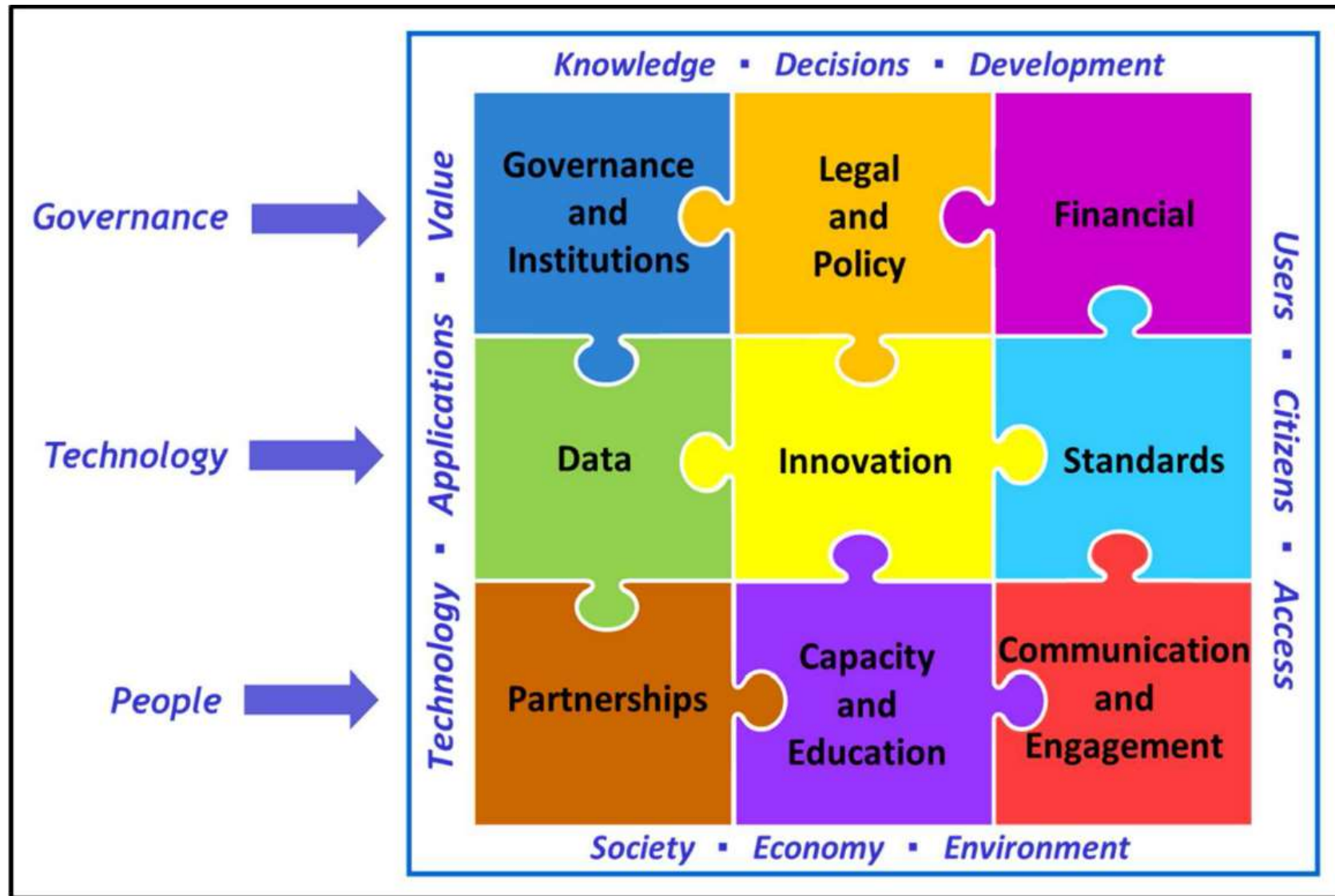

- Digitalization – data-centric approaches
- New technology – data volume, quality and new data sets
- Collaboration – geospatial as a facilitator
- SDGs – the need/purpose of geospatial data

Integrated Geospatial Information Framework



Adopted by UN (UN-GGIM) 1 August 2018

Open data

	Agriculture and forestry	0,20 billion EUR
	ICT	0,45 billion EUR
	Bank and finance	0,27 billion EUR
	Land use planning and development	0,46 billion EUR
	Public sector	0,14 billion EUR

Sweden 2020

- EU Inspire Directive – geospatial data infrastructure
- EU Open Data Directive – high value data sets
 - **Geospatial**
 - Earth Observation and Environment
 - Meteorological
 - Statistical
 - Companies and company ownership
 - Mobility

Scenarios on land administration

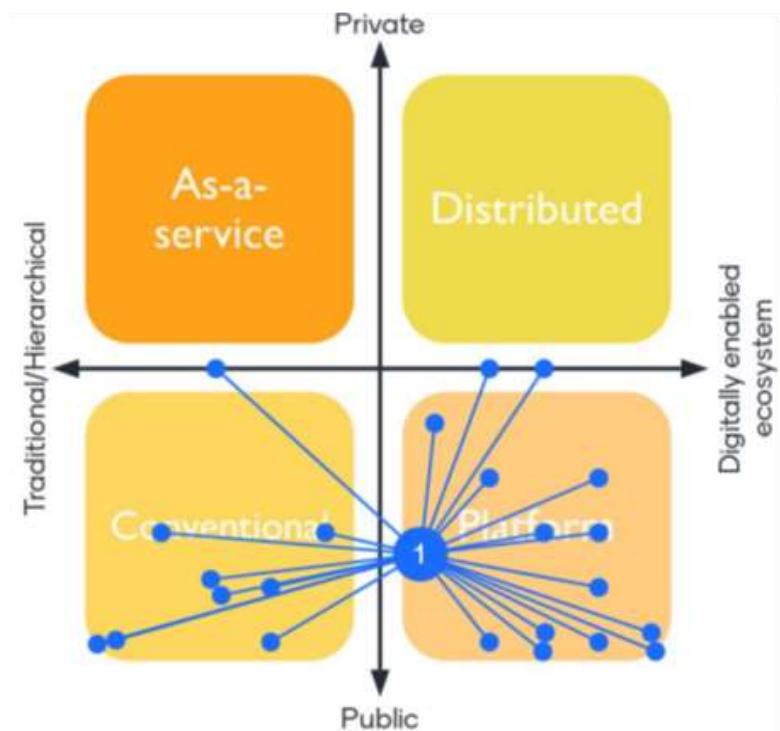

TODAY (JUNE 2021)

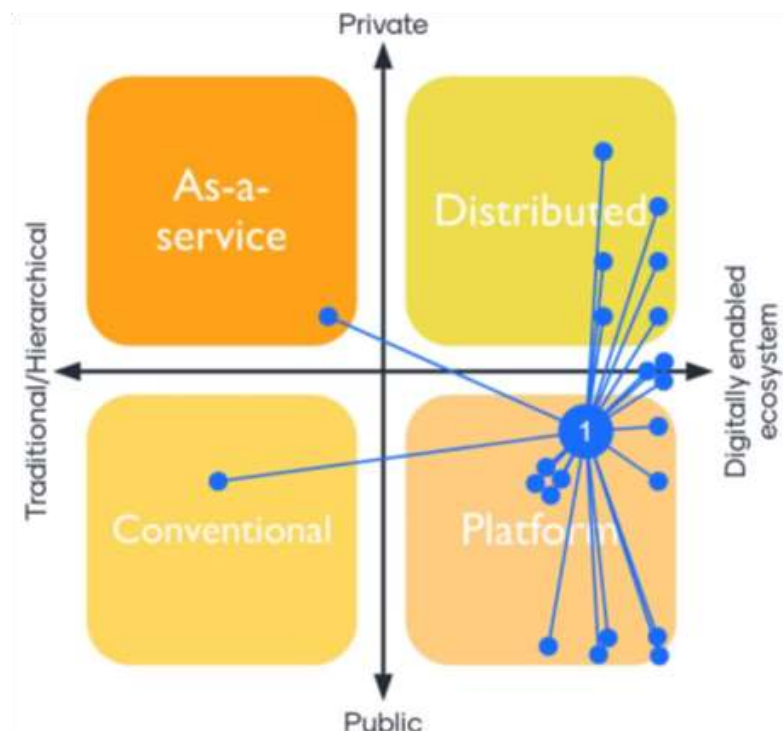

EXPECTED 2030

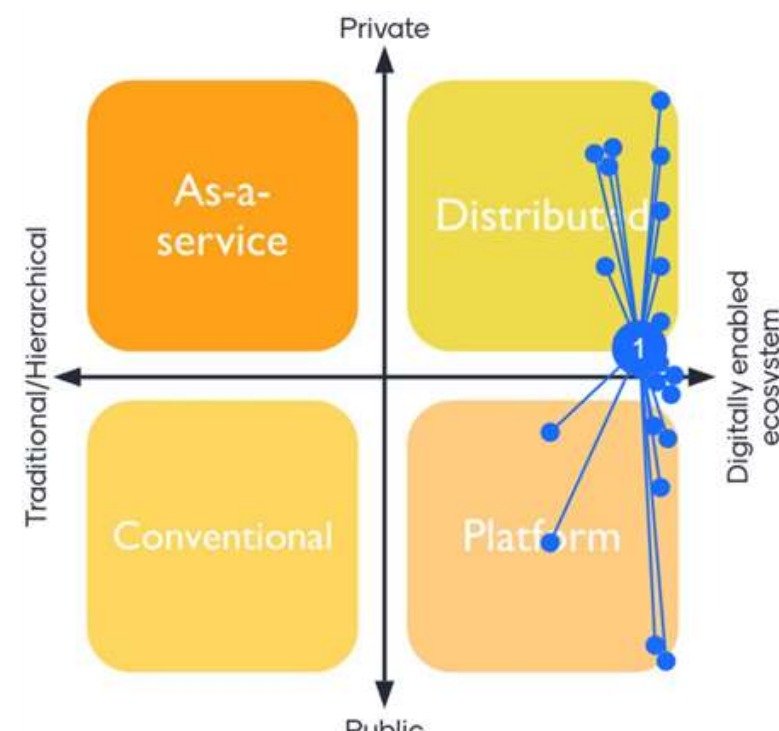

DESIRED 2030

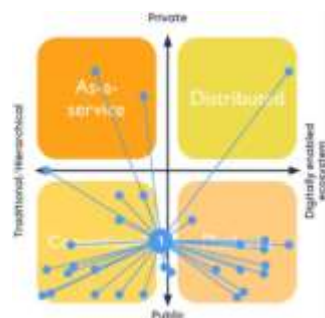

Nov 2019

Interoperability and government as-a-platform

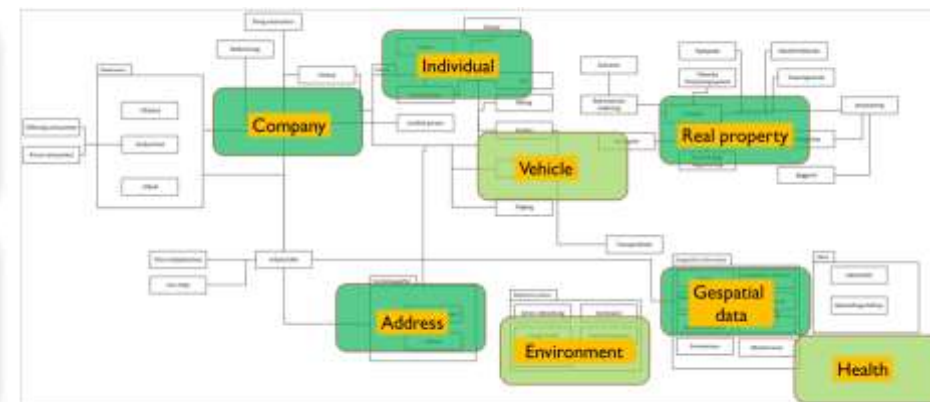
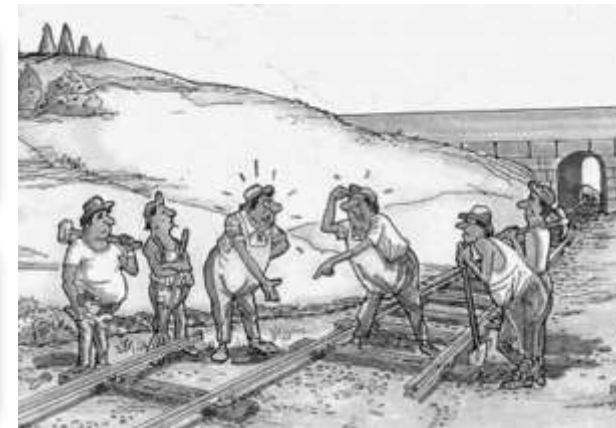

Data interoperability, access and reuse

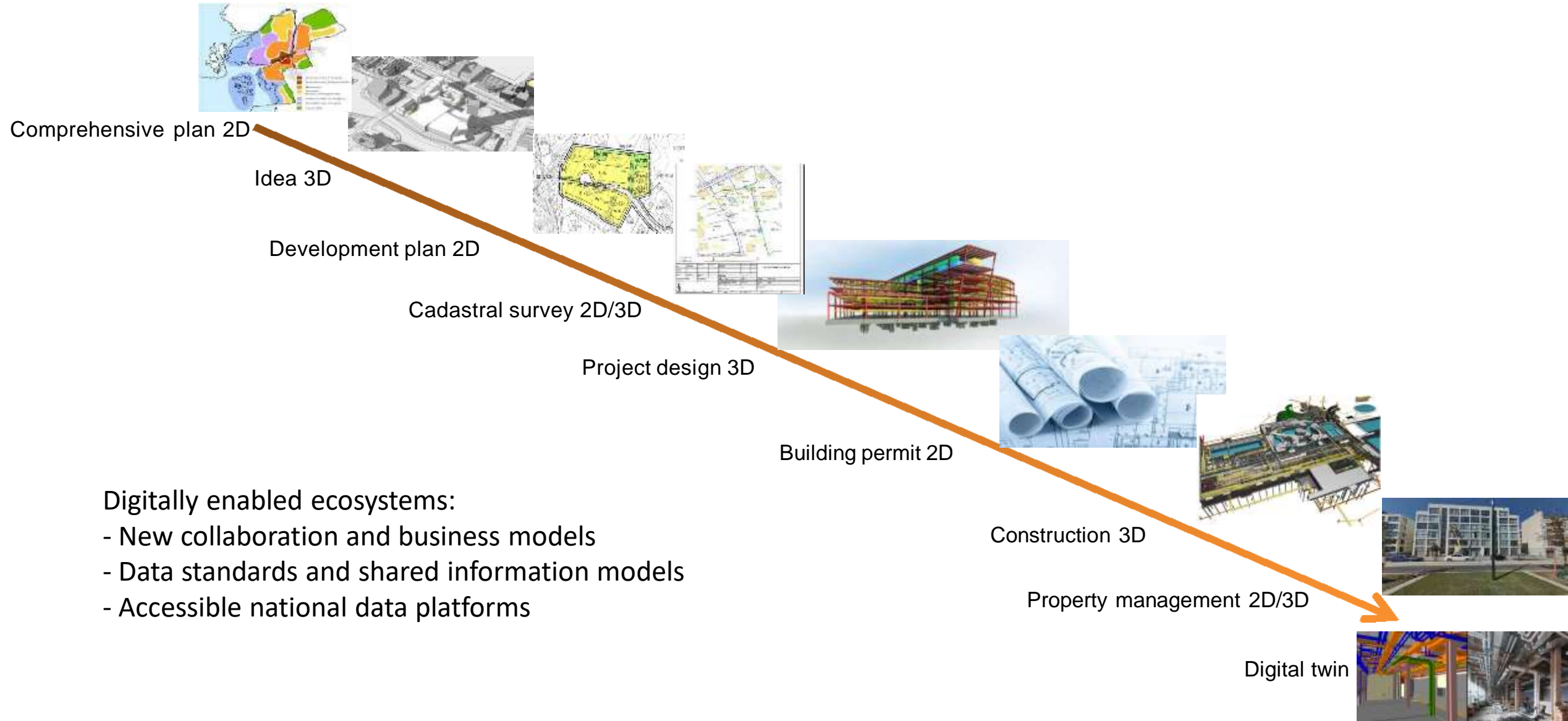

3D geometry representation

Closing the GIS/BIM gap

Development plan

2D



Challenge



3D



Cadastral plan

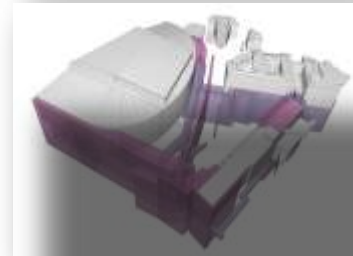
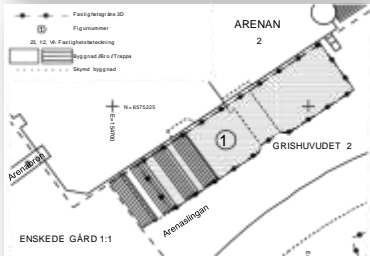

Building permit

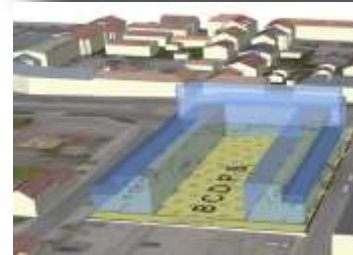

Future process for land use planning and building permit

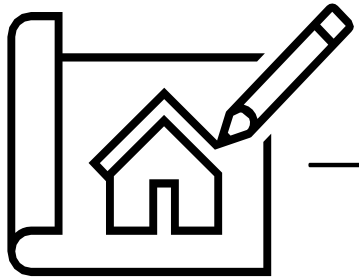

Investor/ Land development company

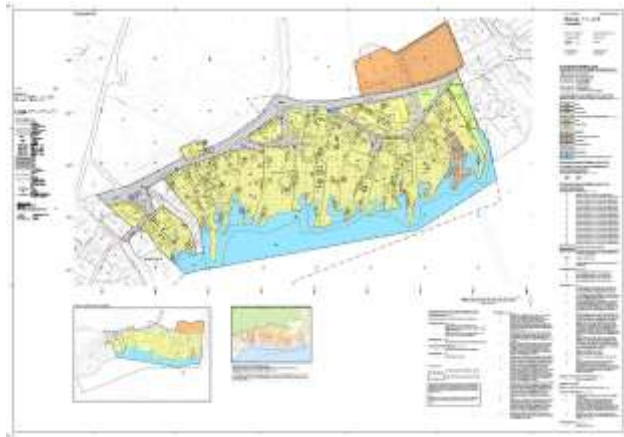
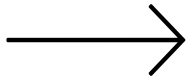

National platform for digital land use plans uploaded by municipalities

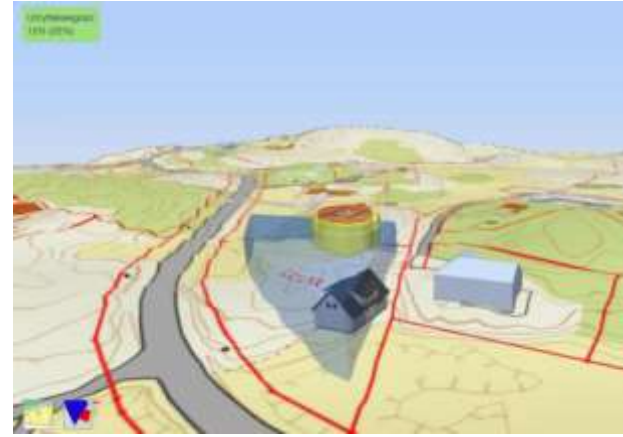
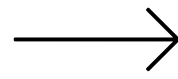

Interactive and automated analysis to ensure that the suggested building (BIM model) fulfill the digital land use plan regulations

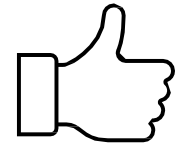
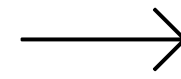

Municipalities issue building permit

National information platform

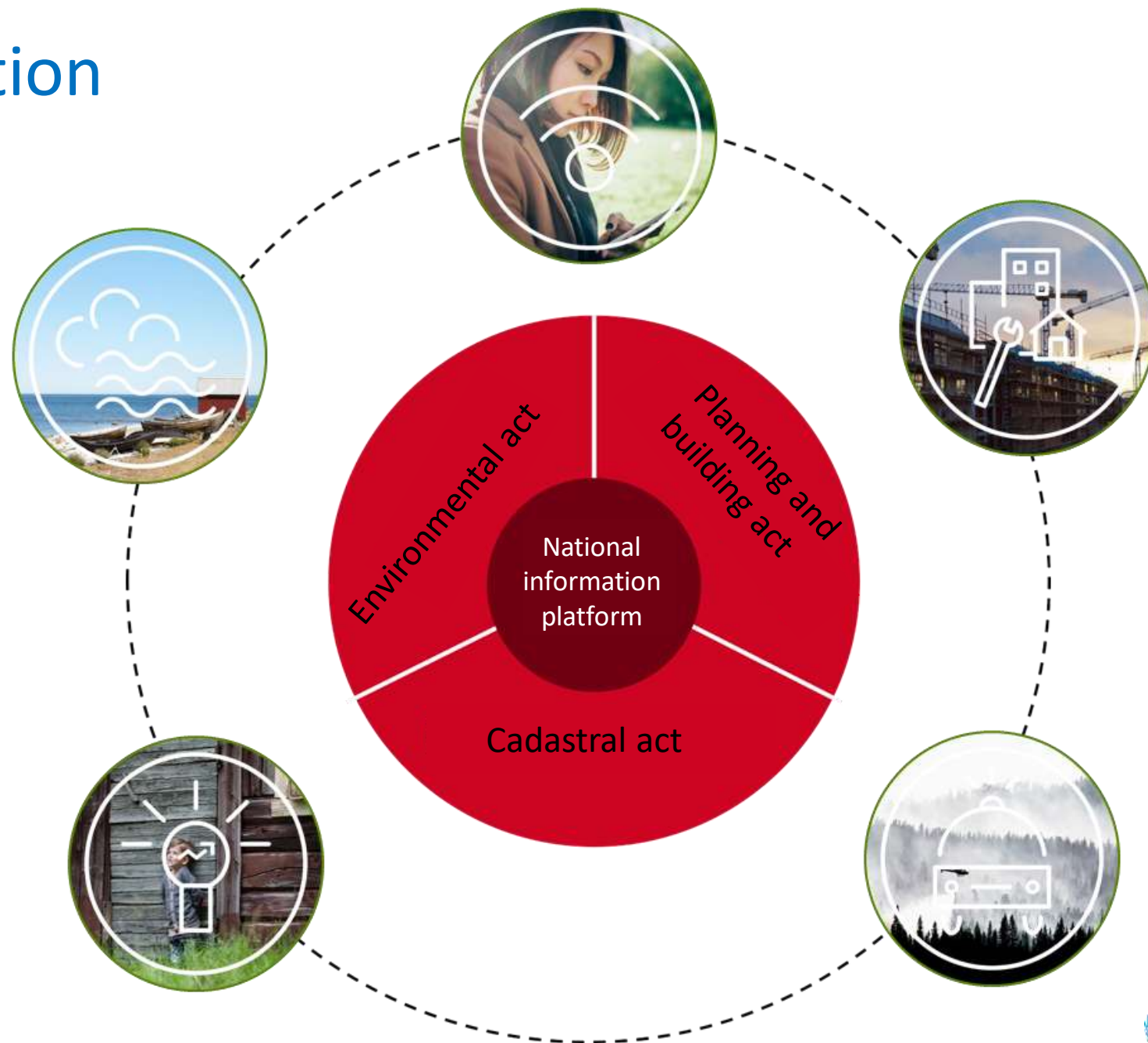

Digital twin

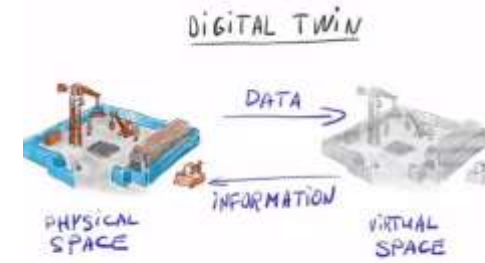

Present

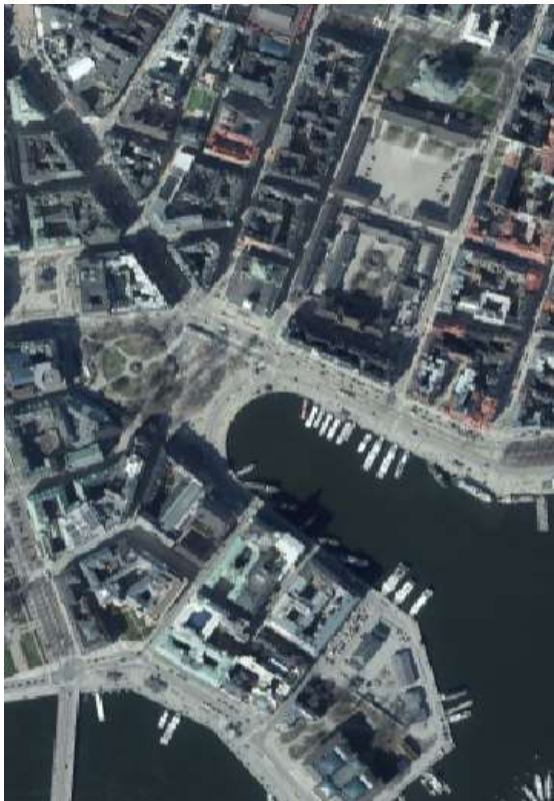

Understand

Real-time



Guide/Manage

Simulated

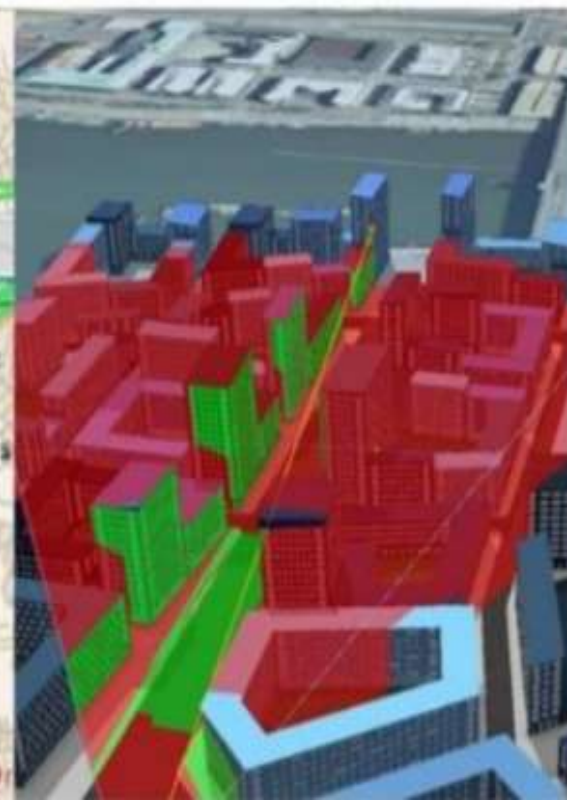

Predict

Parametric design

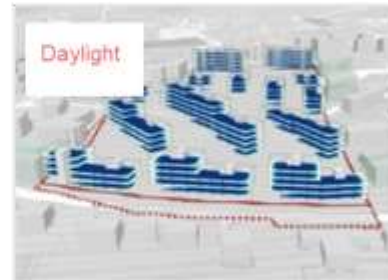
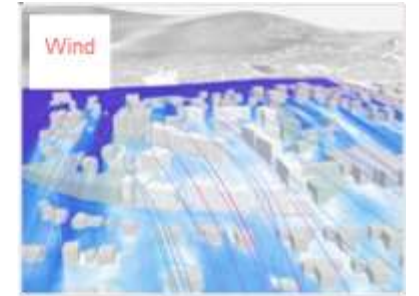
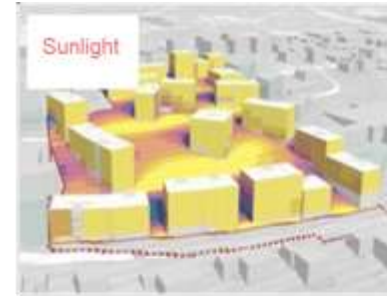
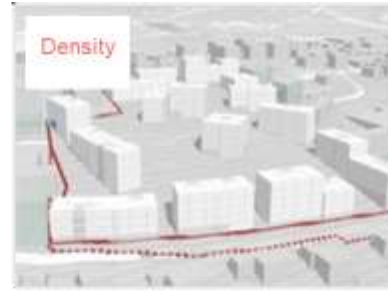

Source: Spacemaker