



Project funded by
the European
Union



The Lebanese
Republic

EuroMed Transport
SUPPORT PROJECT

SAFETY IN TRANSPORT OF CHILDREN SCHOOL

**80th Session
of the Global Forum for Road Traffic Safety
Geneva, 17-20 September 2019**

TANIOS BOULOS

**Gèneral Directeur of Roads and Buildings
Ministry of Public Works and Transport**

Reality, Obstacles, Challenges in Lebanon

In Lebanon, **the number of students** divided among **public, private, subsidized and refugee schools** is **1,077,000** pupils.

According to the assessment made **by the secretariat of the National Road Safety Council**, the **obstacles to safe transport of children to schools and road safety** are as follows:

1

- No organized** public transport.
- Transport is **varied**.
- Private schools have **their own fleet of vehicles**.
- Public schools **do not have this facility**.
- Walking** and **private car transport** is transportation for most other students in Lebanon.

2

- There are **national standards and standards** for student transportation.
- The specifications** of the school buses require each bus **an adult** to accompany students and **a driver**.
- A lack of road safety experience** and culture **among drivers**.



Project funded by
the European
Union



La République
Libanaise

EuroMed Transport
SUPPORT PROJECT

Reality, Obstacles, Challenges in Lebanon

A lack of security around schools
Especially for public schools:

- ❑ Signs
- ❑ Traffic calming measure
- ❑ Passages for pedestrians
- ❑ Sidewalks
- ❑ Areas of care

The challenges are enormous:

- ❑ **Lack of funds** to generalize the public transportation of students. (Public schools)
- ❑ **Failure to guarantee** vehicles meeting the standards required for the transportation of students. (Private schools)
- ❑ **The weak enforcement of the law** regarding the standards of student transport vehicles and likewise for **the maximum number** of students allowed to carry

The organization of a second post in the afternoon for **the education of Syrian refugee children** has become **an additional challenge** for their security.

The National Road Safety Council has launched **a program** to improve transport.

Some **NGOs** participate in the road safety sensation for schoolchildren.



Project funded by
the European
Union



La République
Libanaise

EuroMed Transport
SUPPORT PROJECT

Speed limits in school zones

School zones are installed to **reduce traffic speed** near schools during **the times indicated** in the school zone sign.

School zones are identified **by signs** which are displayed on both **approaches to the school** and show the speed limit and the times during which it applies.

School zones are generally permitted **on roads adjacent** to schools where there is significant school related activity **on and beside the road**.



Project funded by
the European
Union



The Lebanese
Republic

EuroMed Transport
SUPPORT PROJECT

Provide adequate facilities for children to use

- Refuge / traffic island, median
- Kerb extension
- Pedestrian traffic signals
- Road narrowing, indented parking
- Pedestrian fencing
- Ect...

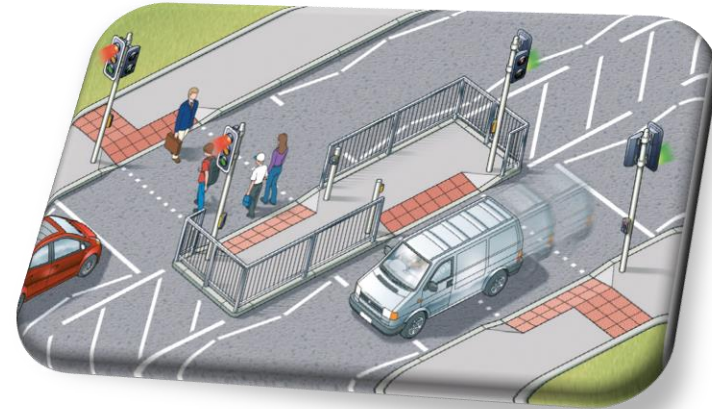

Project funded by
the European
Union



The Lebanese
Republic

EuroMed Transport
SUPPORT PROJECT

School Warning Treatments

General Warning signs that may be used to warn motorists of the likely presence of school children on or crossing the road **near schools include:**

- 'Children'
- 'Pedestrians'
- 'Bicycles'
- 'School'
- 'Blind'
- 'Preschool'
- 'Disabled'
- 'Crossing Ahead'



Project funded by
the European
Union



The Lebanese
Republic

EuroMed Transport
SUPPORT PROJECT

Typical threshold treatment for a school zone

Threshold treatments may be provided **at entrances** to school zones to create **a change in driver perception** of the speed environment.

In the absence of a school zone, threshold treatments may be used to define the school precinct.

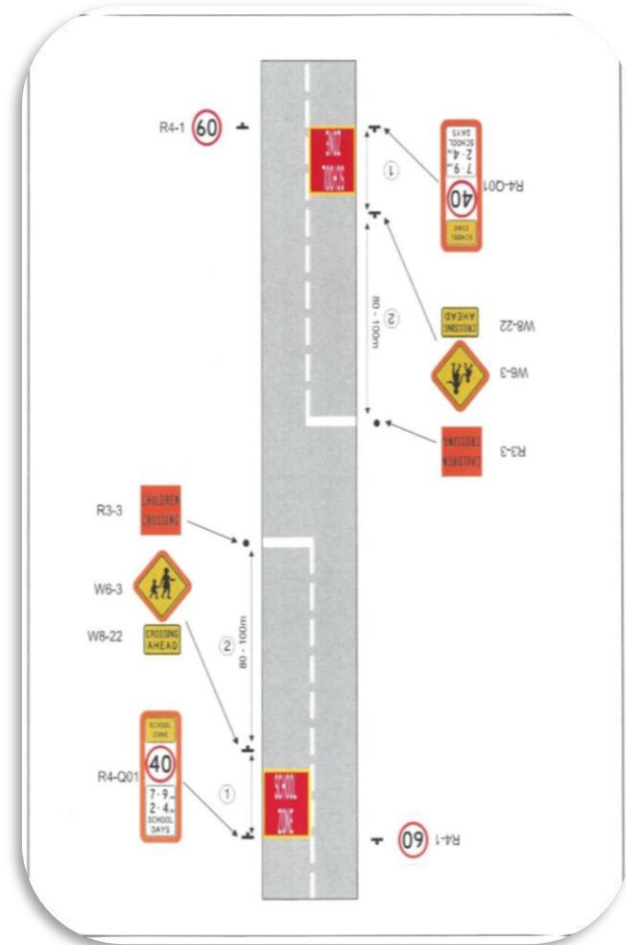

Project funded by
the European
Union



The Lebanese
Republic

EuroMed Transport
SUPPORT PROJECT

Typical threshold treatment for a school zone

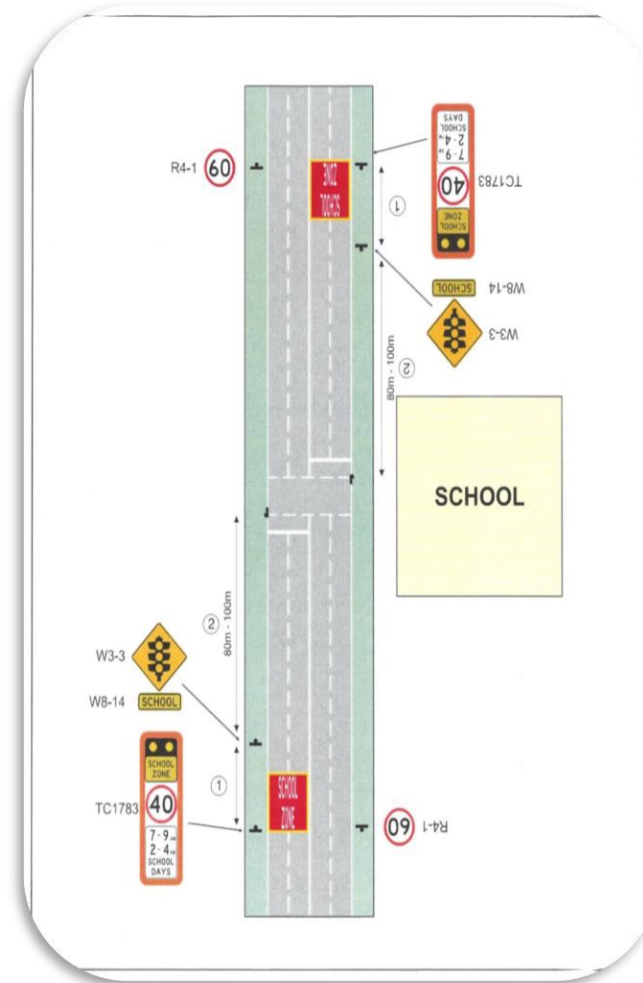
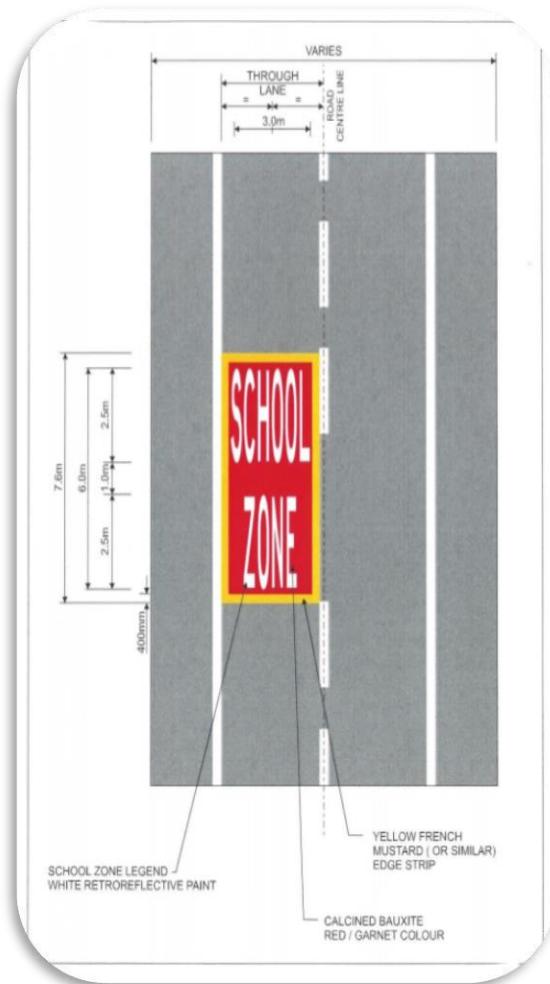

Project funded by
the European
Union



The Lebanese
Republic

EuroMed Transport
SUPPORT PROJECT

Provide Crossing Supervisor

Crossing Supervisors are in charge of ensuring that pedestrians get across roadways safely. They take control of the flow of traffic and stop all vehicles from proceeding so that the pedestrians can **cross** safely.



Project funded by
the European
Union



The Lebanese
Republic

EuroMed Transport
SUPPORT PROJECT



Project funded by
the European
Union



The Lebanese
Republic

EuroMed Transport
SUPPORT PROJECT

THANKS