

Paragraph 6.1.6., the reference to "paragraph 1.42.", amend to read "paragraph 1.20."

Paragraph 7.2.1.2., amend to read:

" in the position of actual unlocking and when projected into a plane perpendicular to the button's initial direction of motion: for enclosed devices two dimensions forming the prescribed area."

Paragraph 8.2.1.1.2., amend to read:

" or the vehicle without opening the buckle. A tension of 200 ± 2 N shall be applied to the buckle. If the buckle is attached to a rigid part, the force shall be applied reproducing the angle formed between the buckle and that rigid part during the dynamic test."

Annex 6, appendix 3, figures 1 and 2, the text reading:

" DISTANCE C - R_e = 550 mm
ANGLE "ANG" = 30° MAXIMUM"

amend to read (in each figure):

" DISTANCE C - R_e = 530 mm
Re is **located on** the centerline of the retractor spool
ANGLE "ANG" = 30° MAXIMUM"

Annex 13,

Paragraph 2., amend to read: */

" two anchorages points (A1 and A2) (see Figure 1), and a central part (N, in detail in Figure 3). The retractor

Paragraph 3., amend to read:

"

Belt retractor R shall be fitted to trolley anchorage such that the spool centre-line is positioned on Re

The value of X in Figure 1 below is 200 ± 5 mm. The **effective** strap length between A1 and the centre-line of the retractor spool Re (**when the webbing is fully extracted including the minimum length of 150 mm***) for testing of universal and semi-universal categories shall be 2820 ± 5 mm when measured in a straight line without load and on a horizontal surface; this length may be increased for testing of restricted category; for all categories with the child restraint installed there shall be a minimum of 150 mm* of strap length on the retractor spool."

Figure 1, amend to read :

“

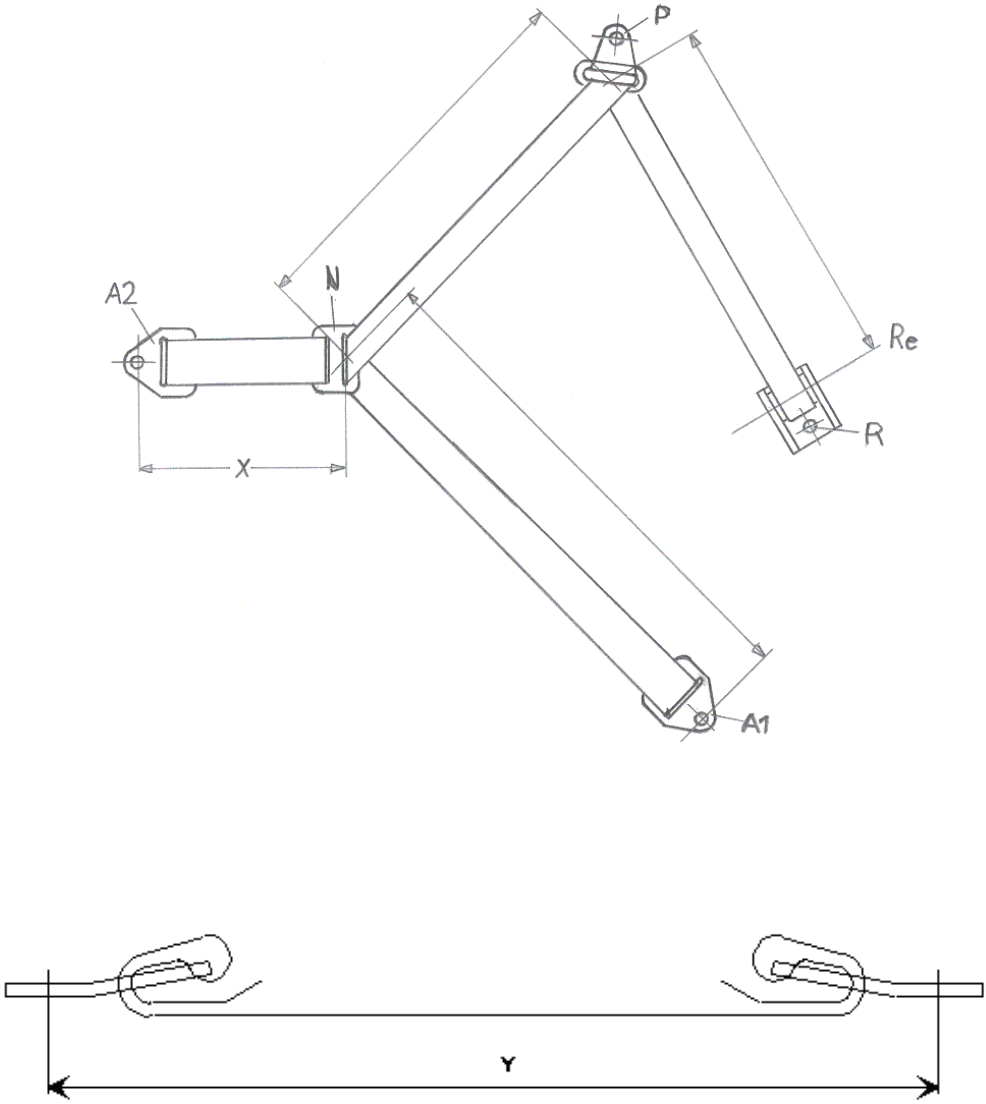

“

* * *