



**Economic and Social
Council**

Distr.
RESTRICTED

TRANS/WP.29/GRSP/2003/11
24 March 2003

Original: ENGLISH
ENGLISH AND FRENCH ONLY

ECONOMIC COMMISSION FOR EUROPE

INLAND TRANSPORT COMMITTEE

World Forum for Harmonization of Vehicle Regulations (WP.29)

Working Party on Passive Safety (GRSP)

(Thirty-third session, 2-6 June 2003,
agenda item B.1.6.)

**PROPOSAL FOR DRAFT AMENDMENTS TO REGULATION No. 44
(Child restraints)**

Transmitted by the Expert from Germany

Note: The text reproduced below was transmitted by the expert from Germany on behalf of the Technical Services Group on Regulation No. 44 in order to improve the text of the Regulation. It is based on the text of a document distributed without a symbol (informal document No. 14) during the thirty-second session (TRAN/WP.29/GRSP/31, para. 20).

Note: This document is distributed to the Experts on Passive Safety only.

A. PROPOSAL

Paragraph 6.1.6., the reference to "paragraph 1.42.", amend to read "paragraph 1.20."

Paragraph 7.2.1.2., amend to read:

" in the position of actual unlocking and when projected into a plane perpendicular to the button's initial direction of motion: for enclosed devices two dimensions forming the prescribed area."

Paragraph 8.2.1.1.2., amend to read:

" or the vehicle without opening the buckle. A tension of 200 ± 2 N shall be applied to the buckle. If the buckle is attached to a rigid part, the force shall be applied reproducing the angle formed between the buckle and that rigid part during the dynamic test."

Annex 6, appendix 3, figures 1 and 2, the text reading:

" DISTANCE C - R_e = 550 mm
ANGLE "ANG" = 30° MAXIMUM"

amend to read (in each figure):

" DISTANCE C - R_e = 530 mm
Re is **located on** the centerline of the retractor spool
ANGLE "ANG" = 30° MAXIMUM"

Annex 13,

Paragraph 2., amend to read: */

" two anchorages points (A1 and A2) (see Figure 1), and a central part (N, in detail in Figure 3). The retractor

Paragraph 3., amend to read:

"

Belt retractor R shall be fitted to trolley anchorage such that the spool centre-line is positioned on Re

The value of X in Figure 1 below is 200 ± 5 mm. The strap length between A1 and the centre-line of the retractor spool Re for testing of universal and semi-universal categories shall be 2820 ± 5 mm when measured in a straight line without load and on a horizontal surface; this length may be increased for testing of restricted category; for all categories

with the child restraint installed there shall be a minimum of 150 mm of strap length on the retractor spool."

Figure 1, amend to read :

“

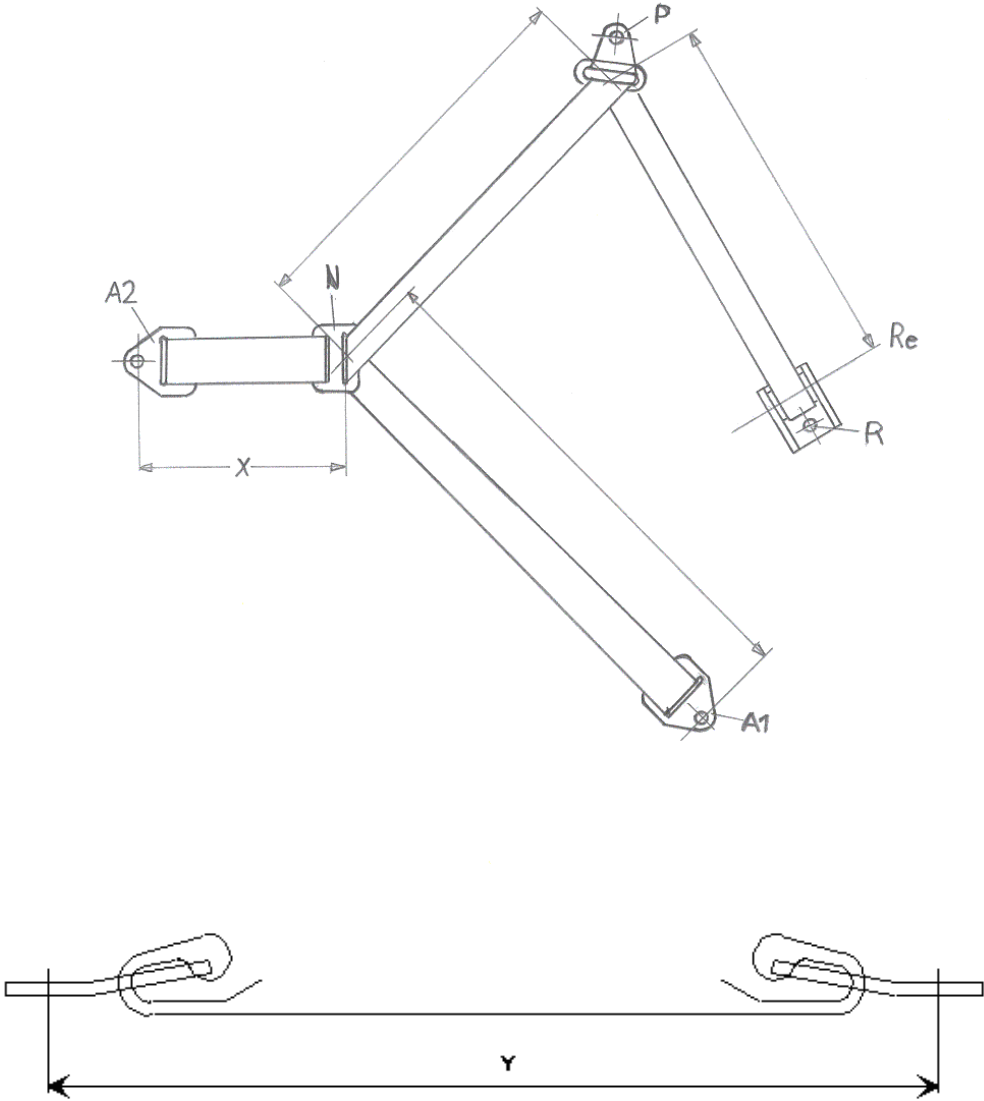

“

* * *

B. JUSTIFICATION

Re. para. 6.1.6.:

The respective prescription has had this editorial change: no technical change.

Re. Para. 7.2.1.2.:

Necessary clarification of the amendment in Supplement 3 because of different interpretation possibilities.

Re. Para. 8.2.1.1.2.:

The amendment in Supplement 3 afforded unrealistic buckle constructions; the old version was better.

Re annexes 6 and 13:

The 03 series of amendments neglected to prescribe a distance between the retractor spool centre line and the retractor anchorage hole. This resulted in different strap lengths. By referring to the spool centre line the strap lengths are always the same ones without prescribing the retractor.
