

Drawing number / Rev
 10332/WK/SL/40_Rev 1

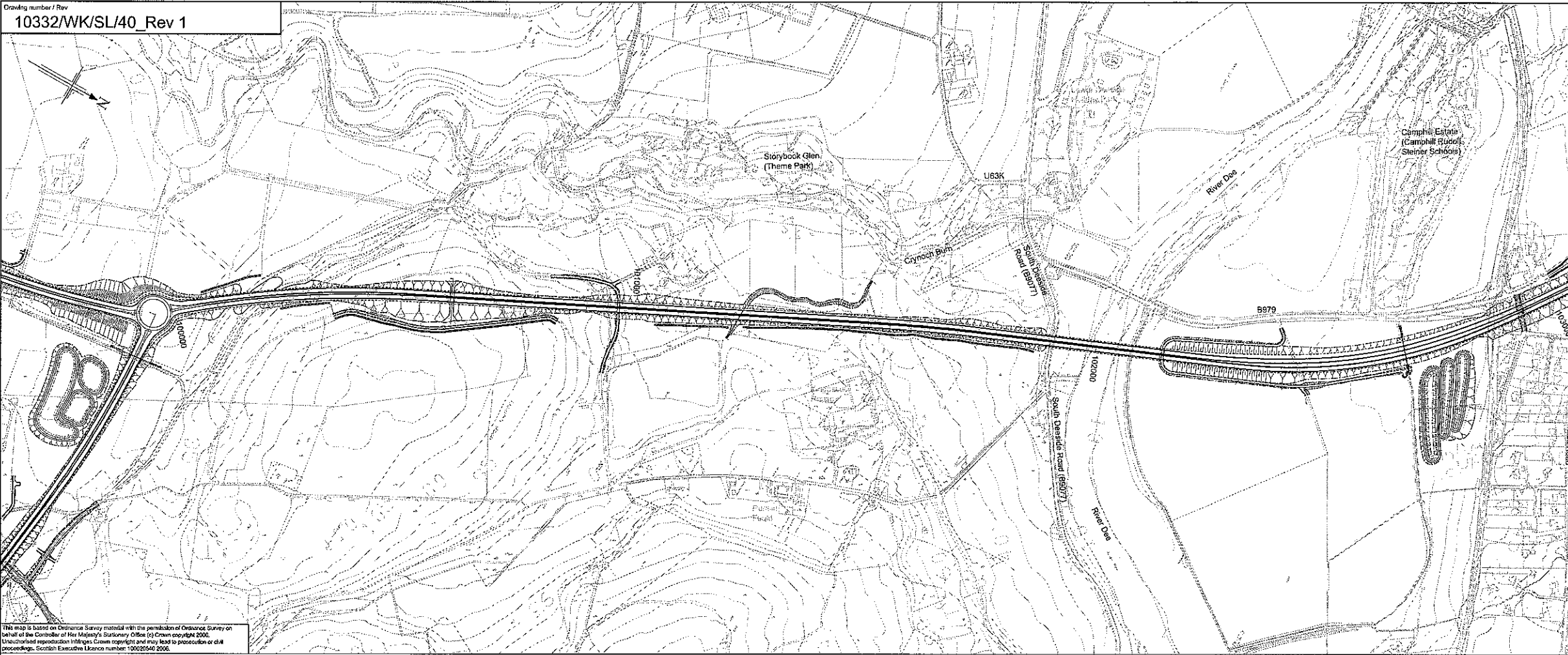

This map is based on Ordnance Survey material with the permission of Ordnance Survey on behalf of the Controller of Her Majesty's Stationary Office (© Crown copyright 2006). Unauthorised reproduction infringes Crown copyright and may lead to prosecution or civil proceedings. Scottish Executive Licence number: 10002540 2006.

Notes
 These drawings are for information only. The layout shown on the plan is indicative only and it will be subject to further design development. These proposals do not show any mitigation.

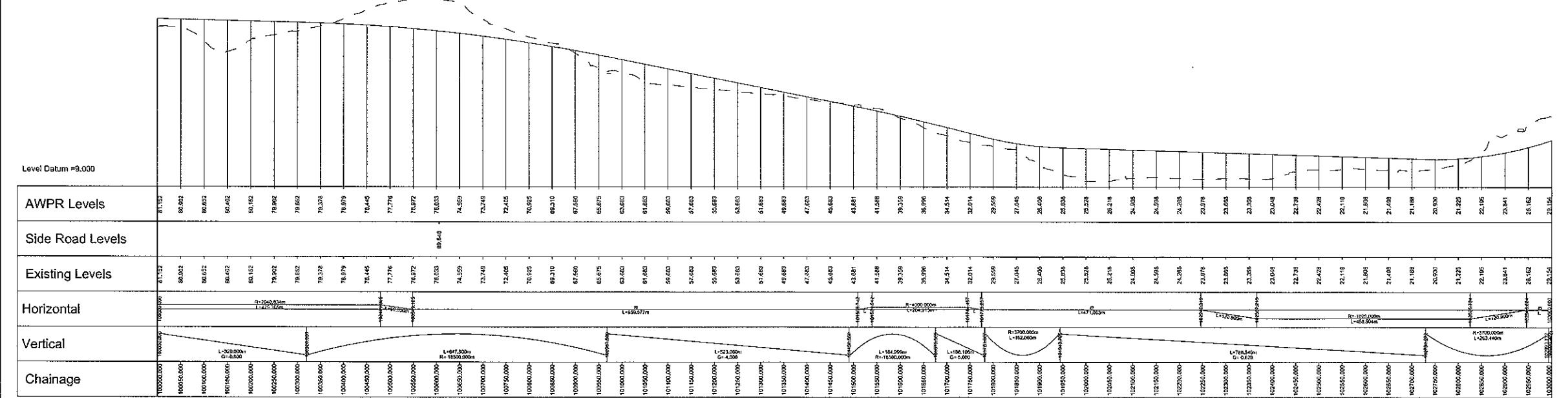

Notes
 These drawings are for information only. The layout shown on the plan is indicative only and it will be subject to further design development. These proposals do not show any mitigation.

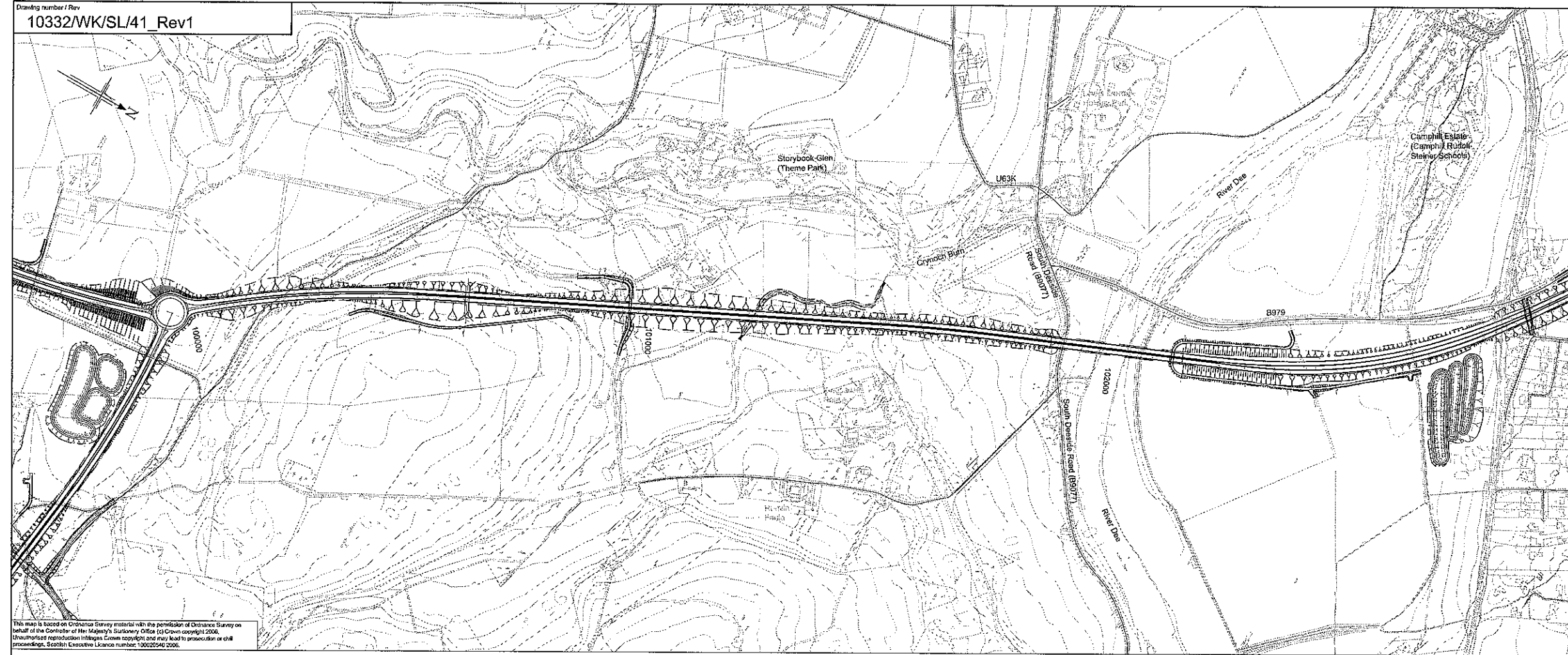

This map is based on Ordnance Survey material with the permission of Ordnance Survey on behalf of the Controller of Her Majesty's Stationery Office (© Crown copyright 2008). Unauthorised reproduction infringes Crown copyright and may lead to prosecution or civil proceedings. Scottish Executive Licence number: 100022540 2008.

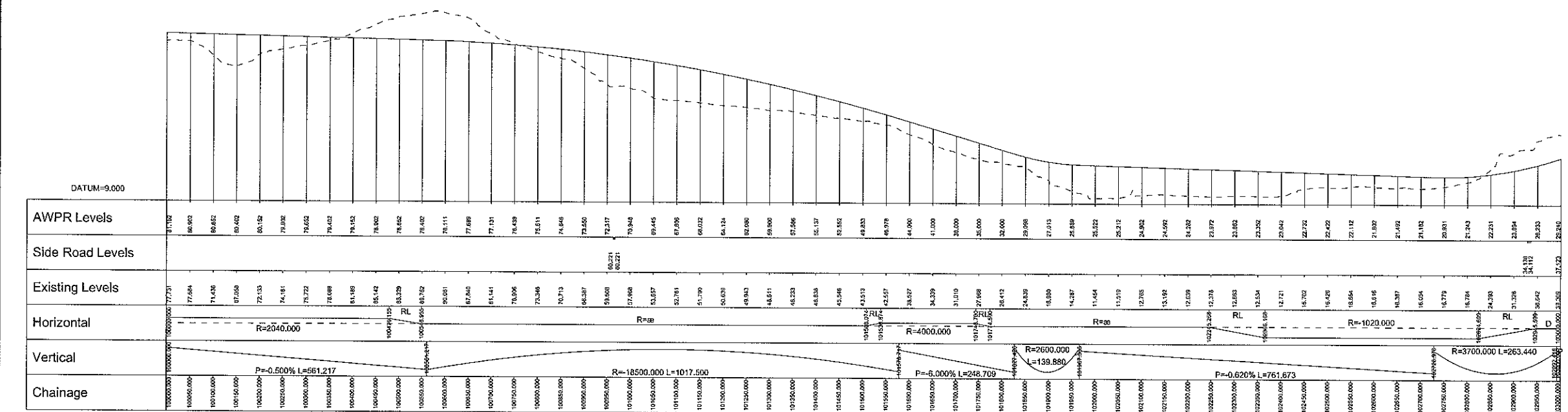

Horizontal = 1:5,000
 Vertical = 1:1,000

1	18/04/07	Permitted	SAU	GAH	CWH
0	10/01/07	Issued for information	RLJ	POC	GAH
Rev	Rev. Date	Purpose of revision	Drawn	Checked	Approved



**SOUTHERN LEG
 KINGCAUSIE - OPTION 1A
 GENERAL PLAN
 CH 100000 - CH 103000**

Drawing status: **PRELIMINARY**
 Scale: 1:5000 @ A1 **DO NOT SCALE**
 Jacobs No. 10332
 Client no.

Drawing number: **10332/WK/SL/41** Rev **1**

This drawing is not to be used in whole or part other than for the intended purpose and project as defined on this drawing. Refer to the contract for full terms and conditions.

Notes
These drawings are for information only. The layout shown on the plan is indicative only and it will be subject to further design development. These proposals do not show any mitigation.

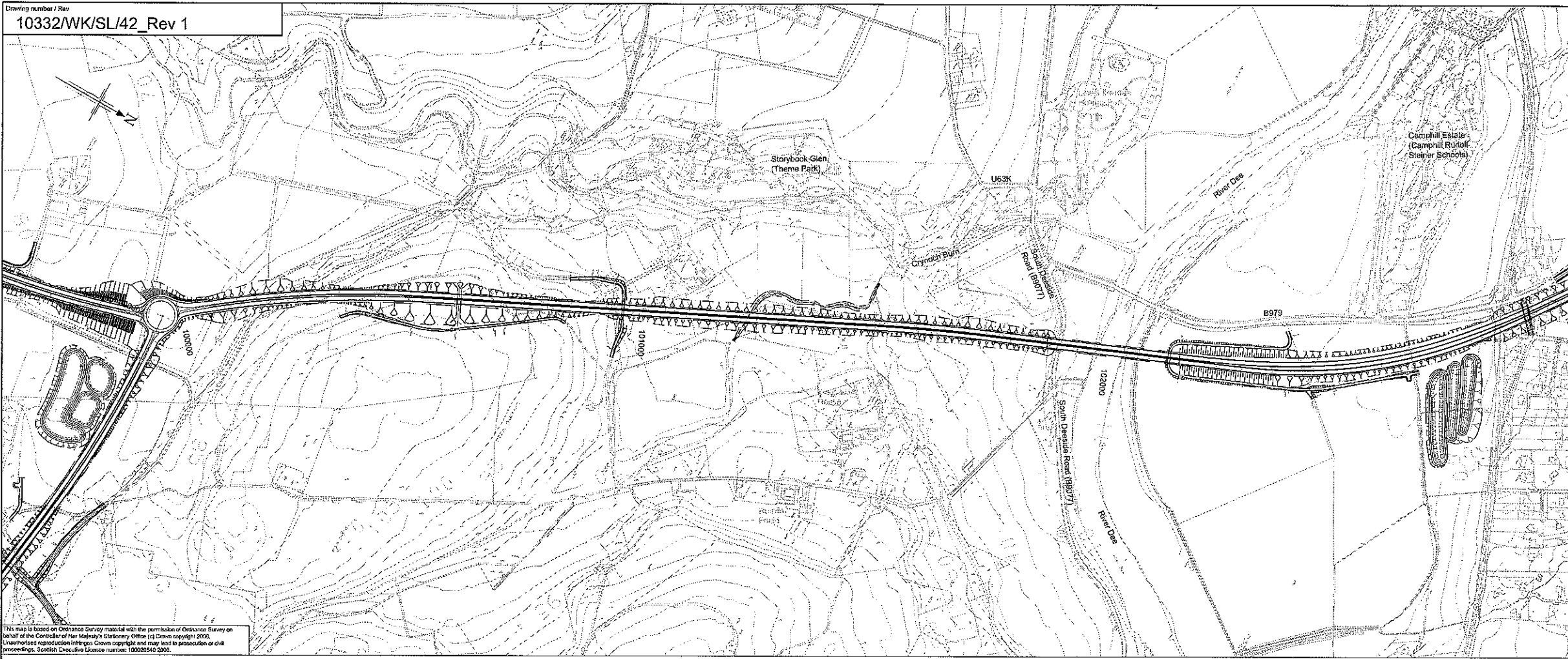

This map is based on Ordnance Survey material with the permission of Ordnance Survey on behalf of the Controller of Her Majesty's Stationery Office (© Crown copyright 2008). Unauthorised reproduction infringes Crown copyright and may lead to prosecution or civil proceedings. Scottish Executive License number: 100005540 2008.

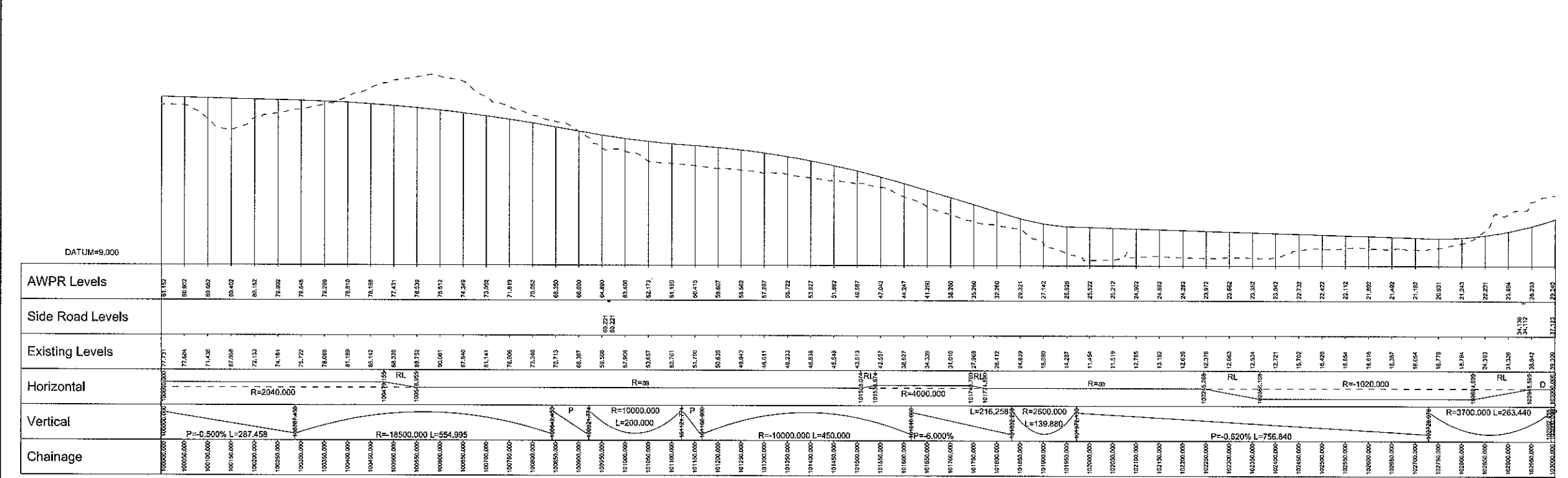

Horizontal = 1:5,000
Vertical = 1:1,000

1	18/04/07	Plan issued	SAJ	GAM	CHW
0	10/01/07	Issued for information	RLT	POC	GAM
Rev	Rev. Date	Purpose of revision	Drawn	Checked	Approved



35 Balmoral St, Glasgow, G2 7JH
Tel: +44(0)141 204 2511 Fax: +44(0)141 229 3100
www.jacobs.com

Drawing title
**SOUTHERN LEG
KINGCAUSIE - OPTION 1B
GENERAL PLAN
CH 100000 - CH 103000**

Drawing status
PRELIMINARY

Scale
1:5000 @ A1
DO NOT SCALE

Jacobs No.
10332

Client no.
10332/WK/SL/42

Rev
1

This drawing is not to be used in whole or part other than for the intended purpose and project as defined on this drawing. Refer to the contract for full terms and conditions.

P:\Data\delivered\london\Edinburgh Highways Team\AWPR\CAD\Kingcausie Option\WK_SL_42_Rev 1.dwg - 18/04/2007 09:25 - Layout1 - auliers

Notes
These drawings are for information only. The layout shown on the plan is indicative only and it will be subject to further design development. These proposals do not show any mitigation.

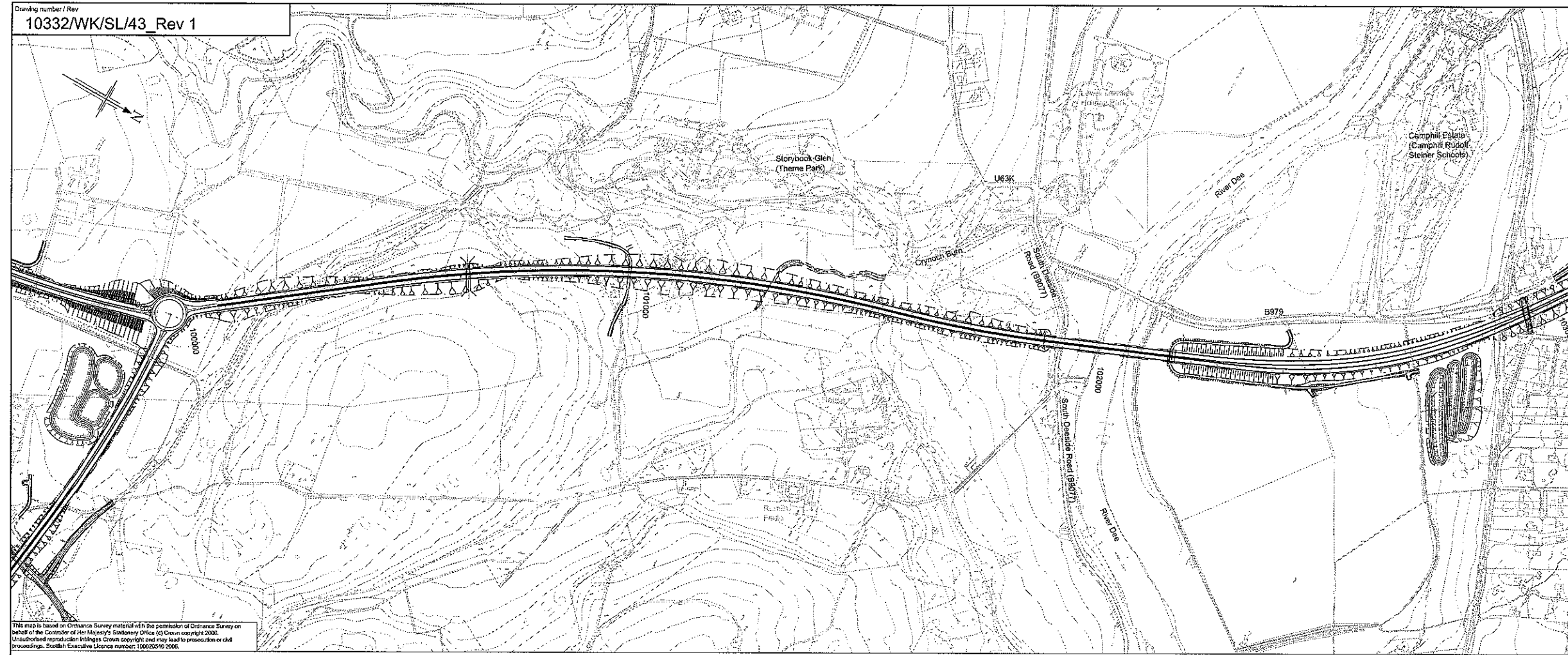

This map is based on Ordnance Survey material with the permission of Ordnance Survey on behalf of the Controller of Her Majesty's Stationery Office (© Crown copyright 2008).
Unauthorized reproduction infringes Crown copyright and may lead to prosecution or civil proceedings. Scottish Executive Licence number: 10002540 2008.

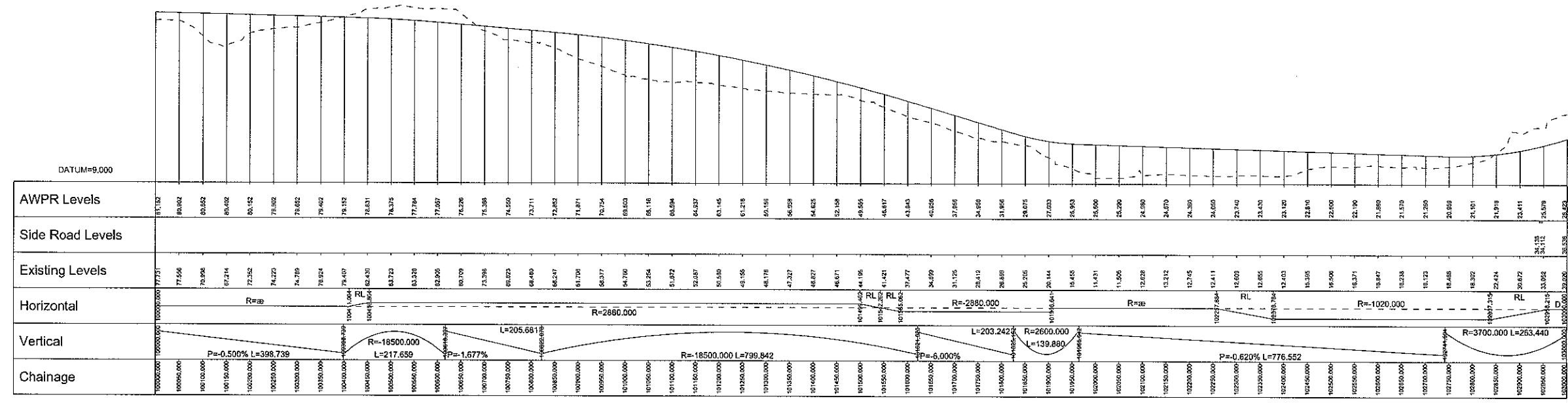

Horizontal = 1:5,000
Vertical = 1:1,000

1	18/04/07	Plan issued	SAU	GAH	CWH
0	10/01/07	Issued for information	RLT	POC	GAH
Rev	Rev. Date	Purpose of revision	Drawn	Checked	Approved



Drawing title
**SOUTHERN LEG
KINGCAUSIE - OPTION 2A
GENERAL PLAN
CH 10000 - CH 103000**

Drawing status	PRELIMINARY	
Scale	1:5000 @ A1	DO NOT SCALE
Jacobs No.	10332	
Client no.		
Drawing number	10332/WK/SL/43	Rev 1
This drawing is not to be used in whole or part other than for the intended purpose and project as defined on this drawing. Refer to the contract for full terms and conditions.		

P:\Data\del\lcb\Jobs\Einburgh Highways 1 Team\AWPR\CAD\Kingcausie Option2A\10332 - Layout1 - a.dwg - 19/04/2007 09:28 - Layout1 - a.dwg

Notes
These drawings are for information only. The layout shown on the plan is indicative only and it will be subject to further design development. These proposals do not show any millgallon.

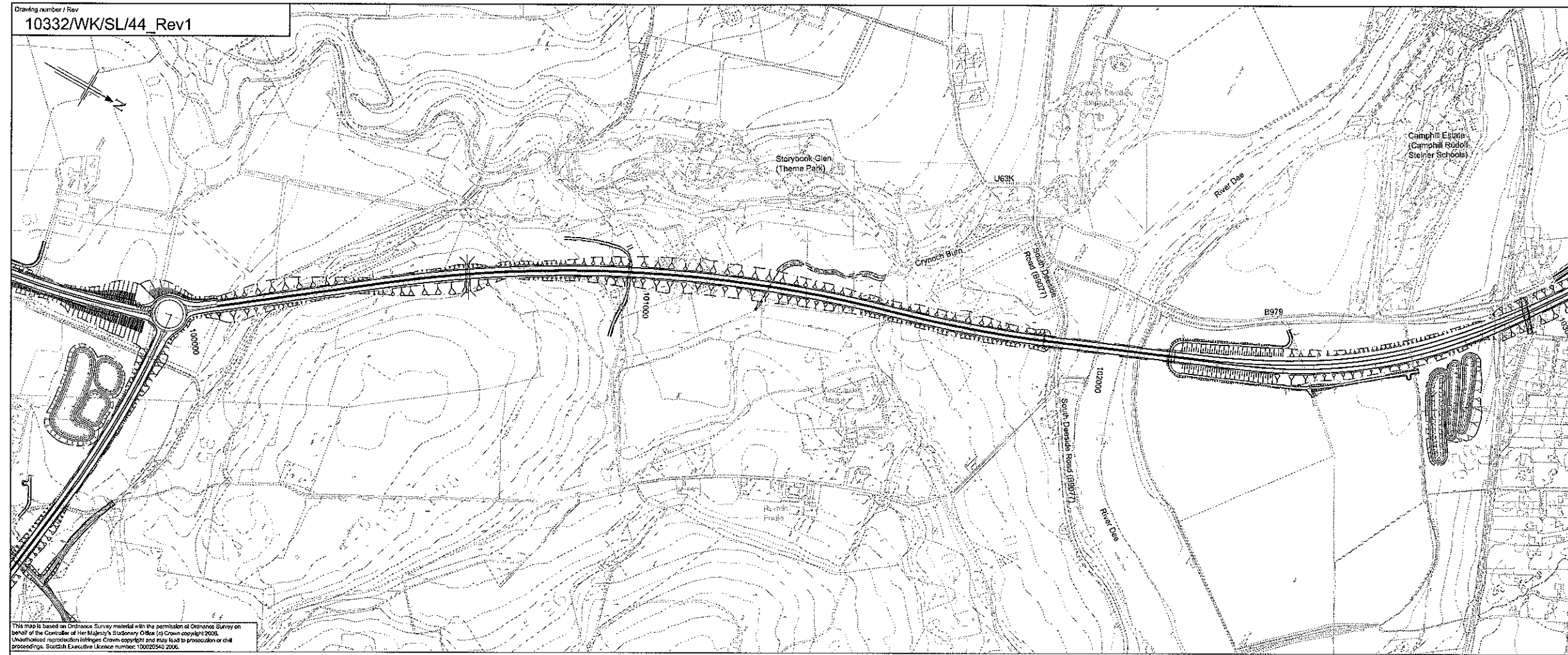

This map is based on Ordnance Survey material with the permission of Ordnance Survey on behalf of the Controller of Her Majesty's Stationery Office (© Crown copyright) 2006. Unauthorised reproduction infringes Crown copyright and may lead to prosecution or civil proceedings. Scottish Executive Licence number: 10002540 2006.

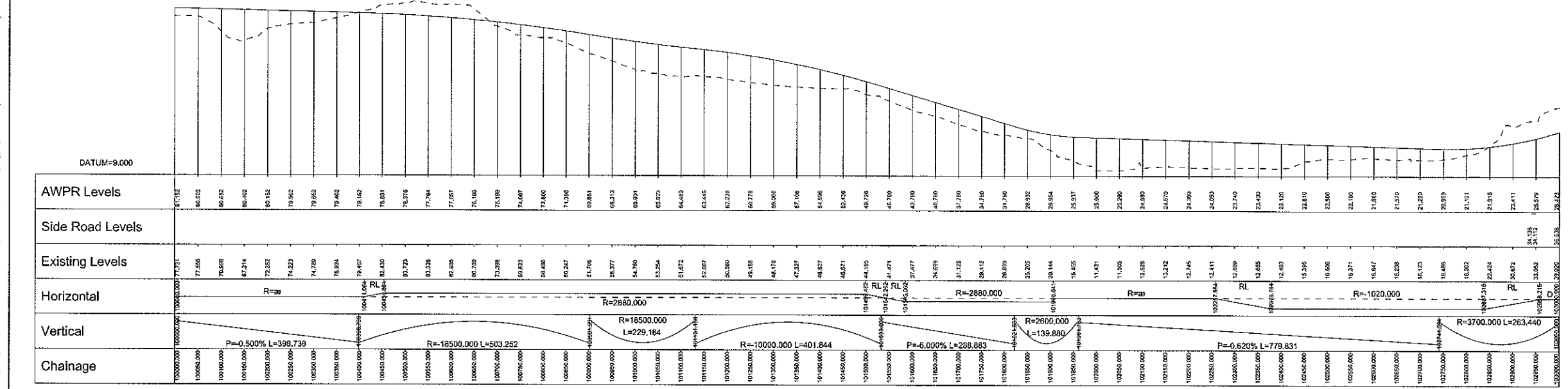

Horizontal = 1:5,000
Vertical = 1:1,000

Rev	Rev. Date	Purpose of revision	SAU	GAH	CWH
1	15/04/07	Plan updated			
0	10/01/07	Issued for information	RLT	POC	GAH



35 Dumbell St, Glasgow, G2 7HX
Tel: +44(0)141 224 2211 Fax: +44(0)141 226 3105
www.jacobs.com

**SOUTHERN LEG
KINGCAUSIE - OPTION 2B
GENERAL PLAN
CH 10000 - CH 103000**

Drawing status:	PRELIMINARY	
Scale:	1:5000 @ A1	DO NOT SCALE
Jacobs No.:	10332	
Client no.:		
Drawing number:	10332/WK/SL/44	Rev
		1

This drawing is not to be used in whole or part other than for the intended purpose and project as defined on this drawing. Refer to the contract for full terms and conditions.

P:\Data\del\leco\Jobs\Edinburgh Highways\Team\AWPR\CAD\Kingcausie Option\WK_SL_44_Rev1.dwg - 19/04/2007 09:26 - Layout1 - augsjens

Drawing number / Rev
10332/WK/SL/47_Rev 1

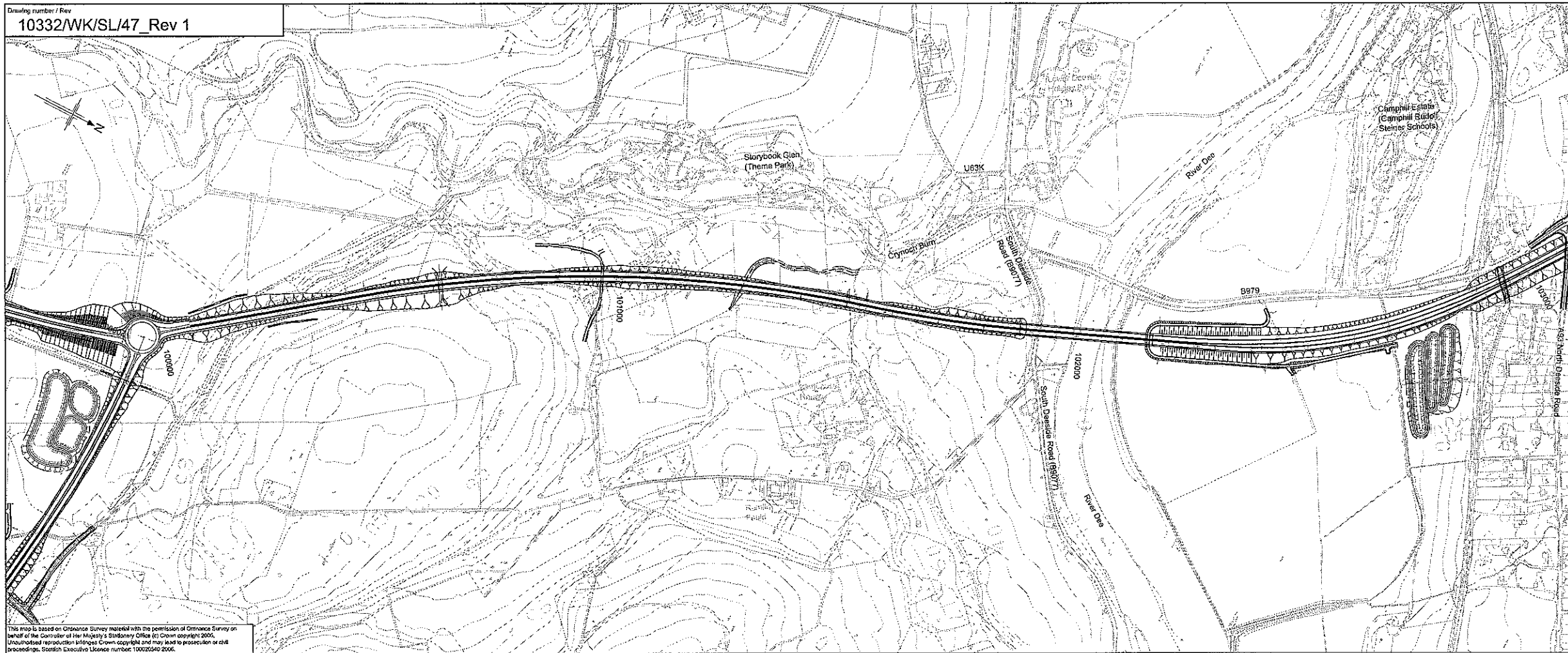

This map is based on Ordnance Survey material with the permission of Ordnance Survey on behalf of the Controller of Her Majesty's Stationery Office (© Crown copyright 2006). Unauthorised reproduction infringes Crown copyright and may lead to prosecution or civil proceedings. Scottish Executive Licence number: 10002540 2006.

Notes
 These drawings are for information only. The layout shown on the plan is indicative only and it may be subject to further design development. These proposals do not show all mitigation.

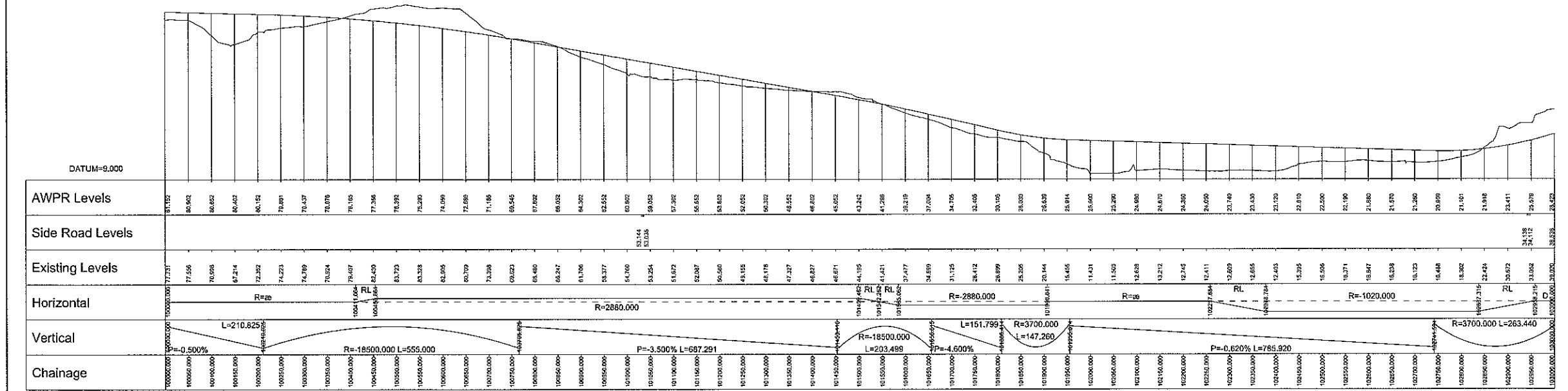

Horizontal 1:5,000
 Vertical 1:1,000

Rev	Rev. Date	Purpose of revision	Drawn	Checked	Approved
1	18/04/07	Plan updated	SAu	GAH	CWH
0	25.01.07	Issued for information	RLT	POC	GAH

JACOBS
 25 Belford St, Glasgow, G2 7JG
 Tel: +44(0)141 204 2511 Fax: +44(0)141 205 3100
 www.jacobs.com

berdeen Western Peripheral Route

Drawing title
**SOUTHERN LEG
 KINGCAUSIE - OPTION 2C
 GENERAL PLAN
 CH 100000 - CH 103000**

Drawing status
PRELIMINARY

Scale
 1:5000 @ A1
DO NOT SCALE

Jacobs No.
 10332

Client no.

Drawing number
10332/WK/SL/47

Rev
1

This drawing is not to be used in whole or part other than for the intended purpose and project as defined on this drawing. Refer to the contract for full terms and conditions.

P:\Data\dm\td\sl\Edinburgh Highways Team\AWPR\CAD\Kingcausie Option\WK\SL\47_Rev1.dwg - 19/04/2007 09:28 - Layout1 - aigjans